

READ THIS FIRST

We have designed your telephone to conform to federal regulations and you can connect it to most telephone lines. However, each device you connect to the phone line draws power from it. This power draw is the device's *ringer equivalence number*, or REN. The REN is on the bottom of your phone.

If you are using more than one phone or other device on the line, add up all the RENs. If the total is more than five (or three in rural areas) your phones might not ring. If ringer operation is impaired, remove one of the devices from the line.

If your phone causes problems on the phone line, the telephone company can disconnect your service. The phone company tries to notify you in advance. If advance notice is not practical, the telephone company notifies you as soon as possible and advises you of your right to file a complaint with the FCC

The phone company can also make changes to its lines, equipment, operations, or procedures that could affect the phone's operation. The phone company notifies you in advance, so you can take the necessary steps to prevent interruption of your phone service.

FCC STATEMENT

Your telephone complies with Part 68 of *FCC Rules*. You must, upon request, provide the FCC registration number and the REN to your telephone company. Both numbers are on the bottom of your phone.

Note: You must not connect your telephone to:

- Coin-operated systems
- Party-line systems
- Most electronic key phone systems

CARE

- Keep the phone dry.
- Handle the phone carefully. Do not drop it.
- Do not use or store the phone in temperature extremes.
- Keep the phone away from dust and dirt.
- Do not modify or tamper with the phone's internal components. Doing so might invalidate the phone's warranty and void your FCC authorization to operate it. If the phone is not operating as it should, take it to your local RadioShack store for assistance. If the trouble is harming the phone lines, the phone company might ask you to disconnect the telephone until you fix the problem.

Limited One-Year Warranty

This product is warranted by RadioShack against manufacturing defects in material and workmanship under normal use for one (1) year from the date of purchase from RadioShack company-owned stores and authorized RadioShack franchisees and dealers. EXCEPT AS PROVIDED HEREIN, RadioShack MAKES NO EXPRESS WARRANTIES AND ANY IMPLIED WARRANTIES, INCLUDING THOSE OF MERCHANTABILITY AND FITNESS FOR A PARTICULAR PURPOSE, ARE LIMITED IN DURATION TO THE DURATION OF THE WRITTEN LIMITED WARRANTIES CONTAINED HEREIN. EXCEPT AS PROVIDED HEREIN, RadioShack SHALL HAVE NO LIABILITY OR RESPONSIBILITY TO CUSTOMER OR ANY OTHER PERSON OR ENTITY WITH RESPECT TO ANY LIABILITY, LOSS OR DAMAGE CAUSED DIRECTLY OR INDIRECTLY BY USE OR PERFORMANCE OF THE PRODUCT OR ARISING OUT OF ANY BREACH OF THIS WARRANTY, INCLUDING, BUT NOT LIMITED TO, ANY DAMAGES RESULTING FROM INCONVENIENCE, LOSS OF TIME, DATA, PROPERTY, REVENUE, OR PROFIT OR ANY INDIRECT, SPECIAL, INCIDENTAL, OR CONSEQUENTIAL DAMAGES, EVEN IF RadioShack HAS BEEN ADVISED OF THE POSSIBILITY OF SUCH DAMAGES.

Some states do not allow the limitations on how long an implied warranty lasts or the exclusion of incidental or consequential damages, so the above limitations or exclusions may not apply to you.

In the event of a product defect during the warranty period, take the product and the RadioShack sales receipt as proof of purchase date to any RadioShack store. RadioShack will, at its option, unless otherwise provided by law: (a) correct the defect by product repair without charge for parts and labor; (b) replace the product with one of the same or similar design; or (c) refund the purchase price. All replaced parts and products, and products on which a refund is made, become the property of RadioShack. New or reconditioned parts and products may be used in the performance of warranty service. Repaired or replaced parts and products are warranted for the remainder of the original warranty period. You will be charged for repair or replacement of the product made after the expiration of the warranty period.

This warranty does not cover: (a) damage or failure caused by or attributable to acts of God, abuse, accident, misuse, improper or abnormal usage, failure to follow instructions, improper installation or maintenance, alteration, lightning or other incidence of excess voltage or current; (b) any repairs other than those provided by a RadioShack Authorized Service Facility; (c) consumables such as fuses or batteries; (d) cosmetic damage; (e) transportation, shipping or insurance costs; or (f) costs of product removal, installation, set-up service adjustment or re-installation.

This warranty gives you specific legal rights, and you may also have other rights which vary from state to state.

RadioShack Customer Relations, Dept. W, 100 Throckmorton St., Suite 600, Fort Worth, TX 76102

We Service What We Sell

3/97



SP-603 32-Memory Speakerphone

- Hands-free Operation
- Handset Volume Control
- Adjustable Ringer
- Touch-Tone or Pulse (Rotary) Dialing
 - Hold
 - Redial
 - Flash
- Programmable Pause
- Desk or Wall Mount
- Hearing Aid Compatible

RadioShack
A Division of Tandy Corporation
Fort Worth, Texas 76102

Owner's Manual
Cat. No. 43-5603

INSTALLING THE PHONE

Connecting the Handset Cord

Plug one end of the coiled modular cord into the jack on the left side of the base, then plug the other end of the cord into the jack on the handset.

Connecting to the Phone Line

Plug one end of the supplied modular phone line cord into the jack on the bottom of the base. Route the cord through one of the channel grooves and plug the other end into a modular phone line jack.

Note: The USOC number of the jack to be installed is RJ11C (RJ11W for a wall jack).

Mounting on the Wall

1. Press the tabs as marked on the bottom of the base to release the mounting bracket and lift it off.
2. Turn the mounting bracket so the keyhole slots on the base and the bracket are aligned in the same direction, then reattach the mounting bracket to the base.
3. Using the keyhole slots, hang the phone on a wall plate. Or, if a wall plate is not available, hang the phone on two vertically aligned screws, set $3\frac{15}{16}$ inches apart.
4. Reverse the handset tab (under the handset) to hold the handset in place.



USING THE PHONE

The SP-603 is preset to touch-tone dialing. To set it to pulse (rotary) dialing, lift the handset (or press **SPEAKER**), then press **PROGRAM # # # 3**. To return to touch-tone dialing, lift the handset and press **PROGRAM # # # 8**.

To temporarily set the phone to touch-tone dialing during a call, press *****. It resets to pulse dialing when you hang up.

Press the switchhook (under the handset) to disconnect a call.

Press **PAUSE** to program a pause in memory (see "Storing/Dialing Numbers in Memory").

Press **FLASH** instead of the switchhook for special services such as Call Waiting.

Press **SPEAKER** to turn the speakerphone on or off. The red indicator lights when the speakerphone is on.

Press **VOLUME ▲** or **▼** to raise or lower speakerphone or handset volume during a call.

Lift the plastic cover off the memory index, then write the name or stored number on the index and replace the cover.

Press **LOWER**, then a memory button, to store a number in the location indicated by the shaded area next to the button.

Press **MUTE** to speak privately with someone else in the room without the caller hearing you. Press **MUTE** again to resume your phone conversation.

Set **RINGER** to **HI** or **Lo** to have the phone sound a high- or low-volume ring. Set it to **OFF** for no ring.

Press **HOLD** to place a call on hold (you can place the handset on the cradle). To return to the call, press the switchhook, lift the handset from the cradle, or press **HOLD** again.

Press **REDIAL** to dial the last number dialed (up to 24 digits).

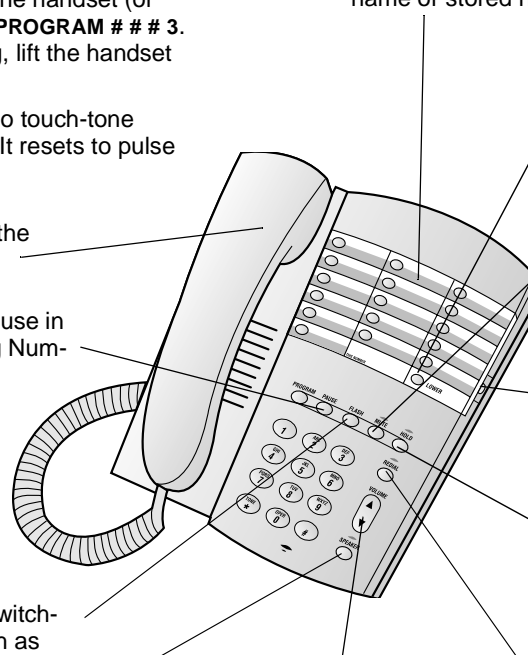

STORING/DIALING NUMBERS IN MEMORY

To store a number in memory:

1. Lift the handset or press **SPEAKER**.
2. Press **PROGRAM**.
3. Enter the number you want to store (up to 24 digits). Or, press **REDIAL** to enter the last number dialed.
Note: To enter a pause of about 3 seconds to access a second dial tone, press **PAUSE**. Each pause entry counts as one digit in memory.
4. Press the memory button (or **LOWER**, then the button) where you want to store the number.

5. Return the handset to the cradle or press **SPEAKER** again.

To dial a number in memory:

1. Lift the handset or press **SPEAKER**.
2. Press a memory button (or **LOWER**, then the button).

Note: If you store an emergency service's number (police, fire department, ambulance) and you want to test the stored number, make the test call during the late evening or early morning hours to avoid peak demand periods. Also, remain on the line to explain the reason for your call.



CAUTION

RISK OF ELECTRIC SHOCK
DO NOT OPEN



This symbol is intended to inform you that parts inside the telephone present a risk of electric shock.



This symbol is intended to alert you to important operating and servicing instructions included in the papers with the telephone.